



输出功率: 约0.3~10.0W

精密金属齿轮减速电机

典型应用: 智能家居
智能机器人
医疗器械
电动玩具

OUTPUT: APPROX 0.3~10.0W

Precision Metal Gear Motor

Typical Applications: Smart Home Appliance
Smart Robot
Medical Instruments
Electric Toys

1. OUTLINE DRAWING:

UNIT:MM

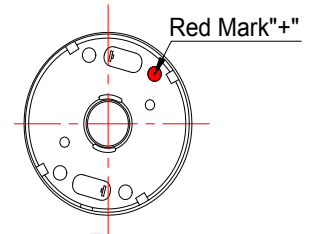
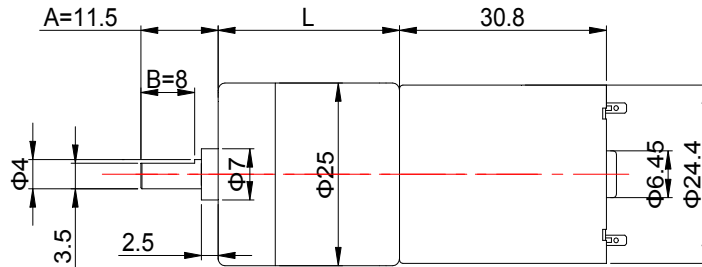
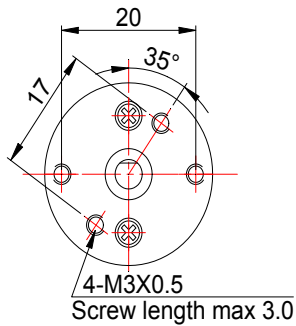

Customizable Parameters:

1. Length L、 A and B
2. Electric Performance
3. Output shaft specifications
4. Reduction Ratio

WEIGHT: 95g(Approx)

View:

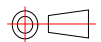

2. GEARBOX REDUCTION RATIO:

| Gearbox Length (mm) | Stage Number | Reduction Ratio | | | | | Rated Torque | Bearable Maximum Instant Torque |
|---------------------|--------------|-----------------|--------|-------|------|--|--------------|---------------------------------|
| | | kg.cm | | | | | | |
| 19 | 4 | 15.5/1 | 20.4/1 | | | | 1.0 | 3.0 |
| 21 | 5 | 26/1 | 30/1 | 34/1 | 45/1 | | 2.0 | 6.0 |
| 23 | 6 | 57/1 | 75/1 | 98/1 | | | 2.5 | 7.0 |
| 25 | 7 | 125/1 | 165/1 | 217/1 | | | 3.0 | 8.0 |
| 27 | 8 | 274/1 | 362/1 | 478/1 | | | 3.0 | 8.0 |

3. MOTOR PERFORMANCE :

1N.m≈10.2kg.cm≈14.2oz.in

| MODEL | REDUCTION RATIO | VOLTAGE | | NO LOAD | | AT MAXIMUM EFFICIENCY | | | | STALL | |
|--------------------|-----------------|-----------------|---------|---------|---------|-----------------------|---------|--------|--------|--------|---------|
| | | OPERATING RANGE | NOMINAL | SPEED | CURRENT | SPEED | CURRENT | TORQUE | OUTPUT | TORQUE | CURRENT |
| | | | V | rpm | A | rpm | A | kg.cm | W | kg.cm | A |
| 25GA370-26-12231 | 26/1 | 3.0~12.0 | 12.0 | 231 | 0.09 | 162 | 0.43 | 1.1 | 1.83 | 3.7 | 1.2 |
| 25GA370-20.4-12400 | 20.4/1 | 3.0~12.0 | 12.0 | 400 | 0.05 | 340 | 0.36 | 0.4 | 1.39 | 2.6 | 2.1 |
| 25GA370-98-0650 | 98/1 | 3.0~6.0 | 6.0 | 50 | 0.05 | 41 | 0.21 | 1.6 | 0.67 | 9.8 | 1.06 |
| 25GA370-165-1288 | 165/1 | 3.0~12.0 | 12.0 | 88 | 0.26 | 43 | 1.27 | 6.0 | 2.65 | 35.3 | 6.2 |
| 25GA370-478-1207.8 | 478/1 | 3.0~12.0 | 12.0 | 7.8 | 0.03 | 7 | 0.07 | 2.0 | 0.14 | 19.5 | 0.52 |